

Kenton C. Ward, CFM
Surveyor of Hamilton County
Phone (317) 776-8495
Fax (317) 776-9628

Suite 188
One Hamilton County Square
Noblesville, Indiana 46060-2230

April 16, 2019

To: Hamilton County Drainage Board

Re: Elwood Wilson Drain, Fisher – County Farm Arm, Field Drive and Cumberland Road Roundabout Reconstruction & Partial Vacation.

The Fisher – County Farm Drain was established by the Hamilton County Commissioners Court per January 23, 1964 report by Roy D. Horney, Hamilton County Surveyor, and approved on February 3, 1964 for the purpose of widening the County Farm Road (north & south). The Fisher - County Farm Drain was later combined with the Elwood Wilson Drain.

Attached are petition from the City of Noblesville along with plans for the proposed reconstruction of a portion of the Elwood Wilson Drain, Fisher – County Farm Arm. The proposal is to reconstruct a portion of the existing drain currently in the Field Drive and Cumberland Road right-of-way per the Field Drive and Cumberland Road Roundabout plans by USI, Project No. 1401714, file stamped 4/4/2019, Sheets 17 and 22.

The Elwood Wilson Regulated Drain, Fisher – County Farm Arm is located on the west side of Cumberland Road. The regulated drain begins at the northwest corner of the existing intersection, crosses under Field Drive, and continues south. Per the construction plans, a new manhole (Str#23) will be added to the existing 12” drain south of the proposed roundabout and approximately 220’ of the existing 12” drain will be removed. (Note: Drainage from the roundabout will be piped via proposed City of Noblesville storm sewers to two detention areas before draining to an existing storm sewer on the east side of Cumberland Road).

This request will consist of the following:

Add Str #23

Remove 220’ of 12” Concrete Tile

The existing drain will be vacated between original station 0+00 and 2+20. This proposal will remove 220' from the drain's total length.

The cost of the project is to be paid by the City of Noblesville. Therefore, the requirement for posting surety has been waived.

The manhole is proposed to be located within the existing Elwood Wilson Drain easement. No easement acquisition is necessary for this reconstruction. Where the existing drain will be vacated, the corresponding easement will likewise be vacated.

I recommend the Board set this item for hearing on May 28, 2019.

Sincerely,

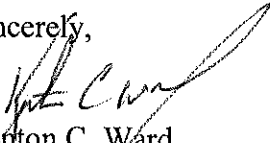

Kenton C. Ward
Hamilton County Surveyor

KCW/pll

HAMILTON COUNTY DRAINAGE BOARD
NOBLESVILLE, INDIANA

IN RE: _____)
Hamilton County, Indiana)

FILED
APR 16 2019

PETITION FOR RELOCATION AND RECONSTRUCTION

OFFICE OF HAMILTON COUNTY SURVEYOR

_____ City of Noblesville _____ (hereinafter "Petitioner"),

hereby petitions the Hamilton County Drainage Board for authority to relocate and improve a section of the Fisher-County Farm Arm, Elwood-Wilson Drain, and in support of said petition advises the Board that:

1. Petitioner owns real estate through which a portion of the Elwood-Wilson Drain runs.
2. Petitioner plans to develop its real estate with roads, buildings, utilities, storm drains, sanitary sewers and other structures.
3. Petitioner's proposed development of its real estate will require relocation and reconstruction of a portion of the Fisher-County Farm Arm, Elwood-Wilson Drain, as specifically shown on engineering plans and specifications filed with the Hamilton County Surveyor.
4. The work necessary for the proposed relocation and reconstruction will be undertaken at the sole expense of the Petitioner and such work will result in substantial improvement to the Fisher-County Farm Arm, Elwood-Wilson Drain, without cost to other property owners on the watershed of the Fisher-County Farm Arm, Elwood-Wilson Drain.
5. Proposed relocation and reconstruction will not adversely affect other land owners within the drainage shed.
6. Petitioner requests approval of the proposed relocation and reconstruction under IC 36-9-27-52.5.

WHEREFORE, Petitioner requests that an Order issued from the Hamilton County Drainage Board authorizing relocation and reconstruction of the Fisher-County Farm Arm, Elwood-Wilson Drain, in conformance with applicable law and plans and specifications on file with the Hamilton County Surveyor.



Signed
James J. Hellmann, P.E. - City of Noblesville

Printed

FINDINGS AND ORDER

CONCERNING THE PARTIAL VACATION OF THE

**Elwood Wilson Drain, Fisher-County Farm Arm,
Field Drive & Cumberland Road Roundabout Reconstruction & Partial Vacation**

Station 0+00 to Station 2+20

On this *28th day of May, 2019*, the Hamilton County Drainage Board has held a hearing on the Maintenance Report and Schedule of Assessments of the **Cool Elwood Wilson Drain, Fisher-County Farm Arm, Field Drive and Cumberland Road Roundabout Reconstruction & Partial Vacation (Station 0+00 to Station 2+20)**.

Evidence has been heard. Objections were presented and considered. The Board then adopted an order of action. The Board now finds that the costs of continued maintenance to the portion of the above drain exceed the benefits to the real estate benefited by the portion of the drain to be abandoned and issues this order vacating the above section of the **Elwood Wilson Drain, Fisher-County Farm Arm, Field Drive and Cumberland Road Roundabout Reconstruction & Partial Vacation (Station 0+00 to Station 2+20)**.

HAMILTON COUNTY DRAINAGE BOARD



President

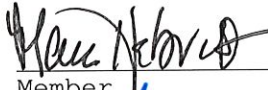

Member



Member

Attest:



STATE OF INDIANA)
) ss:
COUNTY OF HAMILTON)

BEFORE THE HAMILTON COUNTY
DRAINAGE BOARD
NOBLESVILLE, INDIANA

IN THE MATTER OF THE
RECONSTRUCTION OF THE
**Elwood Wilson Drain, Fisher-County Farm Arm, Field Drive and
Cumberland Road Roundabout Reconstruction & Partial Vacation**

FINDINGS AND ORDER FOR RECONSTRUCTION

The matter of the proposed Reconstruction of the **Elwood Wilson Drain, Fisher-County Farm Arm, Field Drive and Cumberland Road Roundabout Reconstruction & Partial Vacation** came before the Hamilton County Drainage Board for hearing **on May 28, 2019**, on the Reconstruction Report consisting of the report and the Schedule of Damages and Assessments. The Board also received and considered the written objection of an owner of certain lands affected by the proposed Reconstruction, said owner being:

Evidence was heard on the Reconstruction Report and on the aforementioned objections.

The Board, having considered the evidence and objections, and, upon motion duly made, seconded and unanimously carried, did find and determine that the costs, damages and expenses of the proposed Reconstruction will be less than the benefits accruing to the owners of all land benefited by the Reconstruction.

The Board having considered the evidence and objections, upon motion duly made, seconded and unanimously carried, did adopt the Schedule of Assessments as proposed, subject to amendment after inspection of the subject drain as it relates to the lands of any owners which may have been erroneously included or omitted from the Schedule of Assessments.

The Board further finds that it has jurisdiction of these proceedings and that all required notices have been duly given or published as required by law.

Wherefore, it is ORDERED, that the proposed Reconstruction of the **Elwood Wilson Drain, Fisher-County Farm Arm, Field Drive and Cumberland Road Roundabout Reconstruction & Partial Vacation** be and is hereby declared established.

Thereafter, the Board made inspection for the purpose of determining whether or not the lands of any owners had been erroneously included or excluded from the Schedule of Assessments. The Board finds on the basis of the reports and findings at this hearing as follows:

HAMILTON COUNTY DRAINAGE BOARD

PRESIDENT



Member

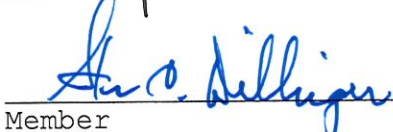

Member

ATTEST: 
Executive Secretary

BEFORE THE HAMILTON COUNTY DRAINAGE BOARD
IN THE MATTER OF

***Elwood Wilson Drain, Fisher County Farm Arm
Field Drive & Cumberland Road Roundabout
Reconstruction & Partial Vacation***

NOTICE

To Whom It May Concern and: _____

Notice is hereby given of the hearing of the Hamilton County Drainage Board concerning the reconstruction of the **Elwood Wilson Drain, Fisher County Farm Arm, Field Drive & Cumberland Road Roundabout Reconstruction & Partial Vacation** on **May 28, 2019** at **9:00 A.M.** in Commissioners Court, Hamilton County Judicial Center, One Hamilton County Square, Noblesville, Indiana. Construction and maintenance reports of the Surveyor and the Schedule of Assessments proposed by the Drainage Board have been filed and are available for public inspection in the office of the Hamilton County Surveyor.

Hamilton County Drainage Board

Attest: Lynette Mosbaugh

ONE TIME ONLY

STATE OF INDIANA)
) SS BEFORE THE HAMILTON
)
COUNTY OF HAMILTON) DRAINAGE BOARD

IN THE MATTER OF **Elwood Wilson Drain, Fisher County Farm
Arm, Field Drive and Cumberland Road Roundabout
Reconstruction & Partial Vacation**

NOTICE

Notice is hereby given that the Hamilton County Drainage Board at its regular meeting **May 28, 2019** adopted the reconstruction report of the Surveyor and the Amended Schedule of damages and assessments including annual assessment for periodic maintenance, finding that the costs, damages and expense of the proposed improvement would be less than the benefits which will result to the owner of lands benefited thereby.

The Board issued an order declaring the proposed improvement established. Such findings and order were marked filed and are available for inspection in the Office of the Hamilton County Surveyor.

If judicial review of the findings and order of the Board is not requested pursuant to Article VIII of the 1965 Indiana Drainage Code as amended within twenty (20) days from the date of publication of this notice, the findings and order shall become conclusive.

HAMILTON COUNTY DRAINAGE BOARD

BY: Christine Altman
PRESIDENT

ATTEST: Lynette Mosbaugh
SECRETARY

KLW

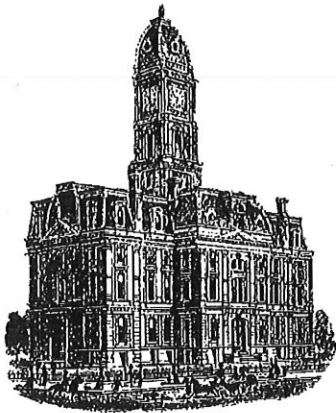

SURVEYOR'S OFFICE
Hamilton County

Kenton C. Ward, CFM
Surveyor of Hamilton County
Phone (317) 776-8495
Fax (317) 776-9628

Suite 188
One Hamilton County Square
Noblesville, Indiana 46060-2230

To: Hamilton County Drainage Board

February 1, 2021

Re: Elwood Wilson: County Farm Arm – Field Dr. & Cumberland Rd. Roundabout and Partial Drain Vacation

Attached are as built and other information for the Field Dr. & Cumberland Rd. Reconstruction. An inspection of the drainage facilities for this section has been made and the facilities were found to be complete and acceptable.

During construction, there were no significant changes made to the drainage plans submitted with my report for this drain dated April 16, 2019. The report was approved by the Board at the hearing held May 28, 2019. (See Drainage Board Minutes Book 18, Pages 431-433) Therefore, the length of the drain remains at **0 feet**. This project removed 220 feet of existing 12" Concrete tile.

The new structure set on the existing Elwood Wilson Drain was done in existing regulated drain easement. The project was paid for by the City of Noblesville.

I recommend the Board approve the drain's construction as complete and acceptable.

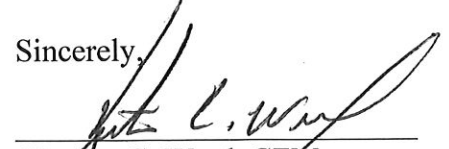
Sincerely,

Kenton C. Ward, CFM
Hamilton County Surveyor

PROJECT	DESIGNATION NO.
1401714	1401714
CONTRACT	
R-38245	

AS-BUILT SURVEY NOTES

- THIS SURVEY WAS PERFORMED FOR THE EXPRESS PURPOSE OF RECORDING THE AS-BUILT LOCATION OF THE UTILITY COMPONENTS ASSOCIATED WITH THE FIELD DRIVE/CUMBERLAND ROAD ROUNDABOUT PROJECT IN NOBLESVILLE, INDIANA.
- ITEMS **SHOWN IN GREEN** ON THESE DRAWINGS INDICATE OBSERVATIONS RECORDED BY UNITED CONSTRUCTION SERVICES.
- ITEMS **SHOWN IN RED** ON THESE DRAWINGS INDICATE OBSERVATIONS RECORDED AS PART OF THE AS-BUILT FIELD SURVEY COMPLETED BY BERTSCH-FRANK & ASSOCIATES, LLC. ALL OTHER INFORMATION IS SHOWN PER PLAN, WAS NOT FIELD VERIFIED AND, AS SUCH, IS NOT CERTIFIED BY BERTSCH-FRANK & ASSOCIATES.
- AS-BUILT STRUCTURE LOCATIONS ARE MEASURED TO THE CENTER OF CASTING AND MAY NOT REPRESENT THE CENTER OF ECCENTRIC STRUCTURES.
- THESE DRAWINGS ARE NOT INTENDED TO BE REPRESENTED AS A RETRACEMENT OR ORIGINAL BOUNDARY SURVEY, A ROUTE SURVEY, OR A SURVEYOR LOCATION REPORT.

AS-BUILT SURVEY CERTIFICATION

THE UNDERSIGNED LAND SURVEYOR, REGISTERED UNDER THE LAWS OF THE STATE OF INDIANA, HEREBY CERTIFIES THAT HE HAS MADE AN AS-BUILT SURVEY OF THE AREA DEPICTED. I HEREBY CERTIFY THAT, TO THE BEST OF MY KNOWLEDGE AND BELIEF, THIS PLAT REPRESENTS AN AS-BUILT SURVEY CONDUCTED UNDER MY DIRECT SUPERVISION.

PROJECT NUMBER: 20388.100
 SURVEYED FOR: UNITED CONSTRUCTION SERVICES
 DATES OF FIELDWORK: NOVEMBER 20, 2020
 JANUARY 7, 2021



Matthew G. Bertsch
 MATTHEW G. BERTSCH, P.L.S.
 INDIANA REGISTERED LAND SURVEYOR NO. 20200087

APPROVED BY
 Board of Public Works And Safety

John Ditslear
 HON. JOHN DITSLER MAYOR

Lawrence J. Stork
 LAWRENCE J. STORK MEMBER

Jack E. Martin
 JACK E. MARTIN MEMBER

ATTEST

Evelyn L. Lees
 EVELYN L. LEES CLERK

Michael A. Howard
 MICHAEL A. HOWARD CITY ATTORNEY

RECOMMENDED FOR APPROVAL

John Beery
 JOHN BEERY, PE, PTOE (ERC) CITY ENGINEER

INDIANA DEPARTMENT OF TRANSPORTATION



ROAD PLANS

1401714 P.E.
 1401714 R/W
 1401714 CONST.

Roundabout Construction at Field Drive / Cumberland Road
 0.25 Miles West of SR 37 on Field Drive in Sections
 29, 30, 31 & 32, T19N, R5E, Noblesville Township, Hamilton County, Indiana

Gross Length: 0.117 Mi.
 Net Length: 0.117 Mi.
 Max. Grade: 3.83%

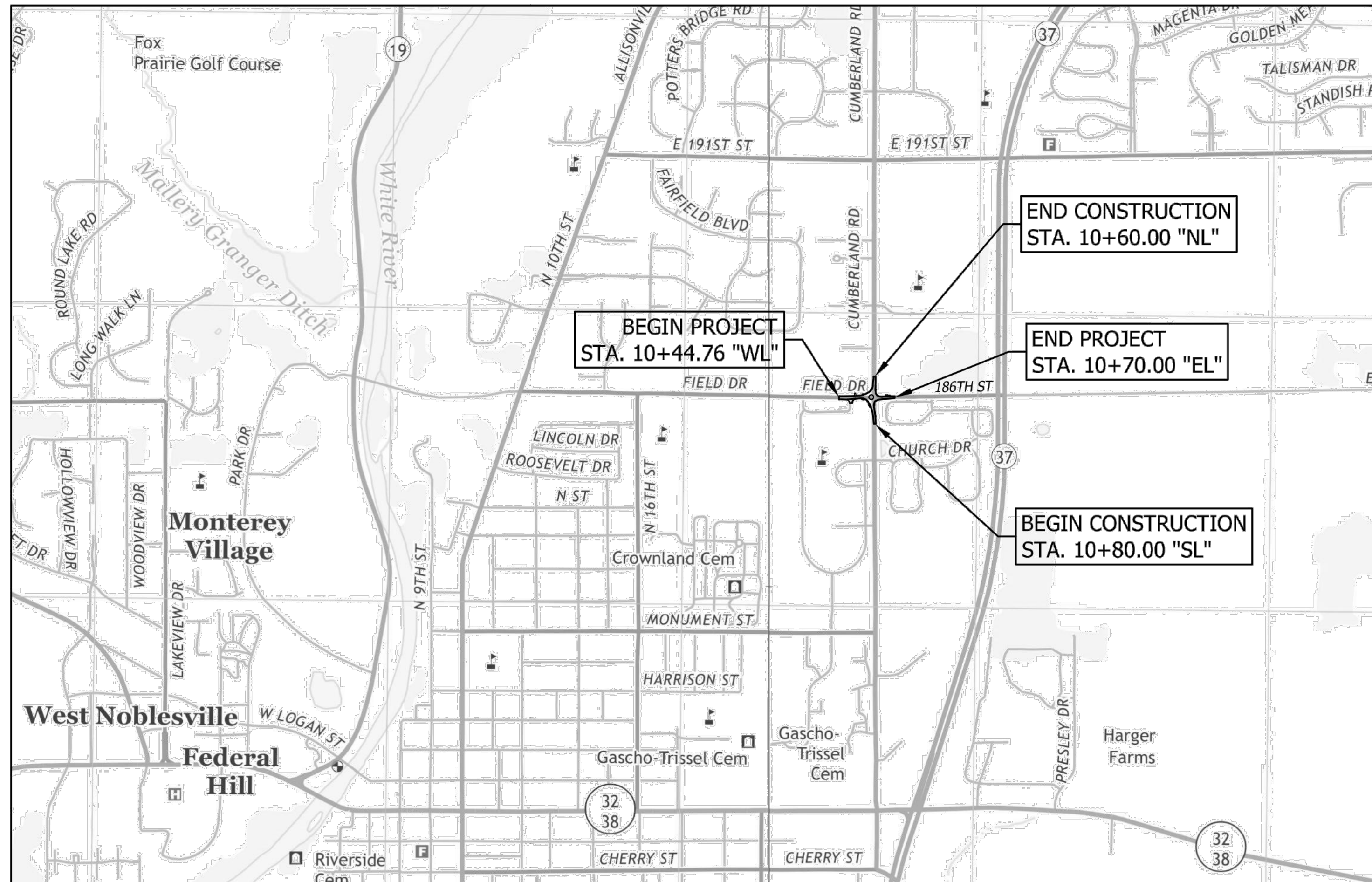

LOCATION MAP

TRAFFIC DATA	FIELD DRIVE
A.A.D.T. (2018)	6120 V.P.D.
A.A.D.T. (2038)	9100 V.P.D.
D.H.V. (2038)	910 V.P.H.
DIRECTIONAL DISTRIBUTION	40% / 60%
TRUCKS	3% D.H.V.
	3% A.A.D.T.
DESIGN DATA	FIELD DRIVE
DESIGN SPEED	30 MPH (25 MPH AT ROUNDABOUT)
PROJECT DESIGN CRITERIA	Reconstruction (Non-Freeway)
FUNCTIONAL CLASSIFICATION	Urban Major Collector
RURAL/URBAN	Intermediate
TERRAIN	Level
ACCESS CONTROL	None

TRAFFIC DATA	CUMBERLAND ROAD
A.A.D.T. (2018)	4210 V.P.D.
A.A.D.T. (2038)	6260 V.P.D.
D.H.V. (2038)	630 V.P.H.
DIRECTIONAL DISTRIBUTION	40% / 60%
TRUCKS	3% D.H.V.
	3% A.A.D.T.
DESIGN DATA	CUMBERLAND ROAD
DESIGN SPEED	30 MPH (25 MPH AT ROUNDABOUT)
PROJECT DESIGN CRITERIA	Reconstruction (Non-Freeway)
FUNCTIONAL CLASSIFICATION	Urban Minor Arterial
RURAL/URBAN	Intermediate
TERRAIN	Level
ACCESS CONTROL	None

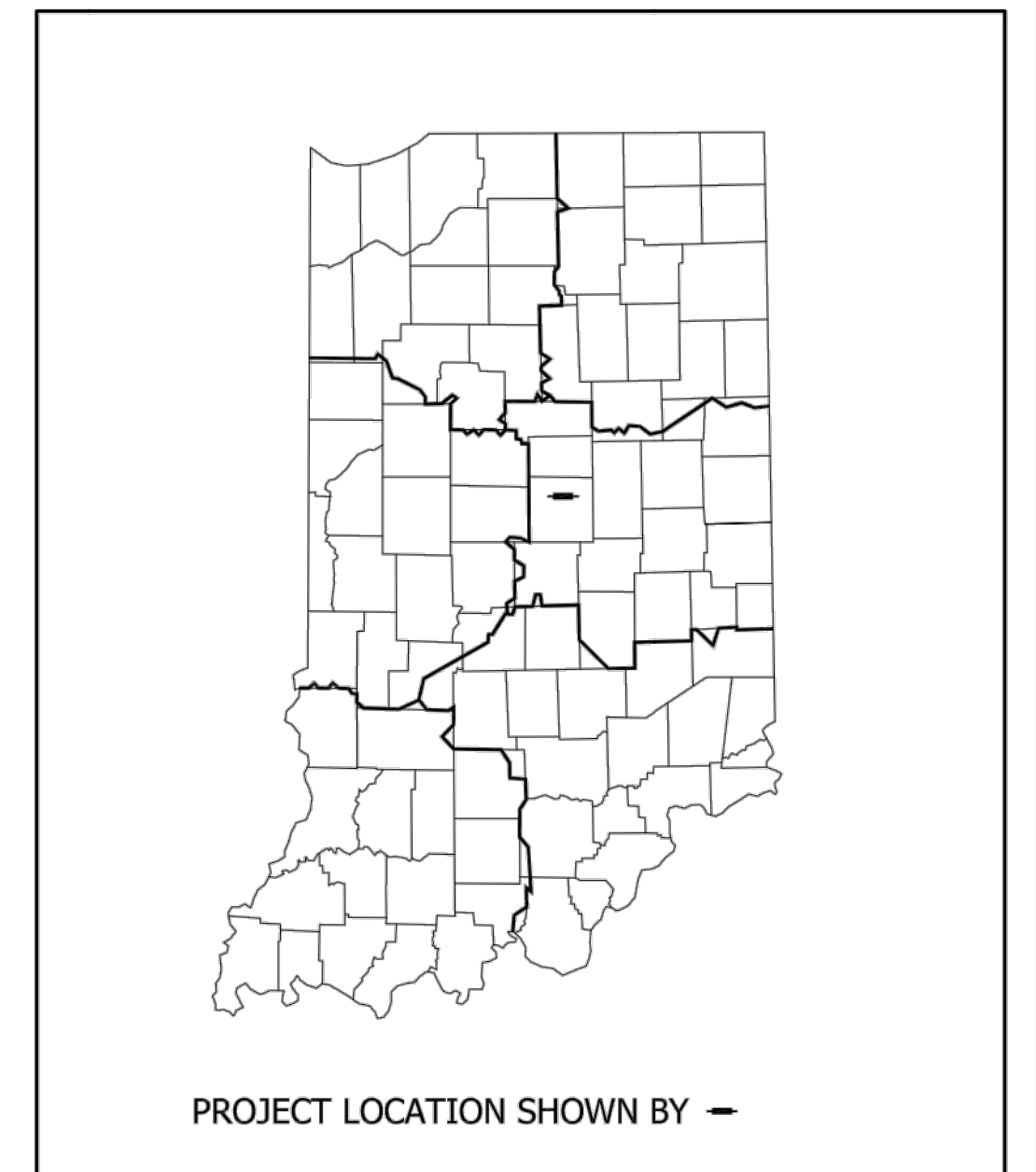
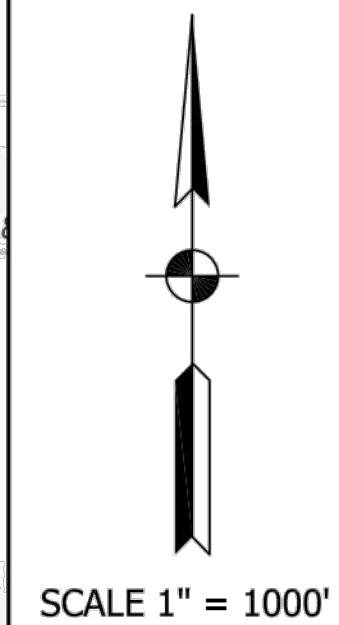

LATITUDE 40° 03' 30" N LONGITUDE 85° 59' 45" W

HUC: 05120201070070

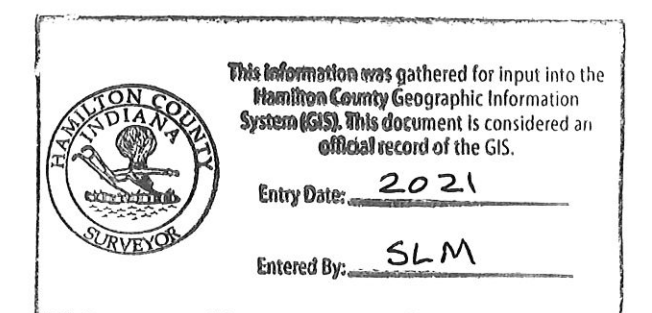

[INDIANA DEPARTMENT OF TRANSPORTATION
 STANDARD SPECIFICATIONS DATED 2018
 TO BE USED WITH THESE PLANS]



PLANS PREPARED BY: **USI Consultants, Inc.** 317-544-4996
 PHONE NUMBER
 CERTIFIED BY: *Michael P. Beery* 7-27-2018 DATE
 APPROVED FOR LETTING: *John S. Wight* 12/11/2018 DATE
 INDIANA DEPARTMENT OF TRANSPORTATION

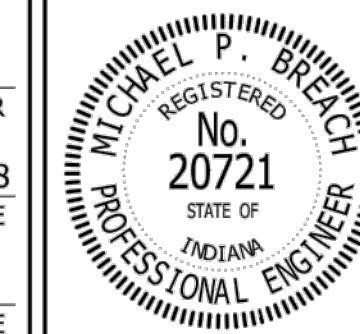

DESIGNATION NO.	1401714
SHEETS	1 of 66
CONTRACT	R-38245
PROJECT NO.	1401714

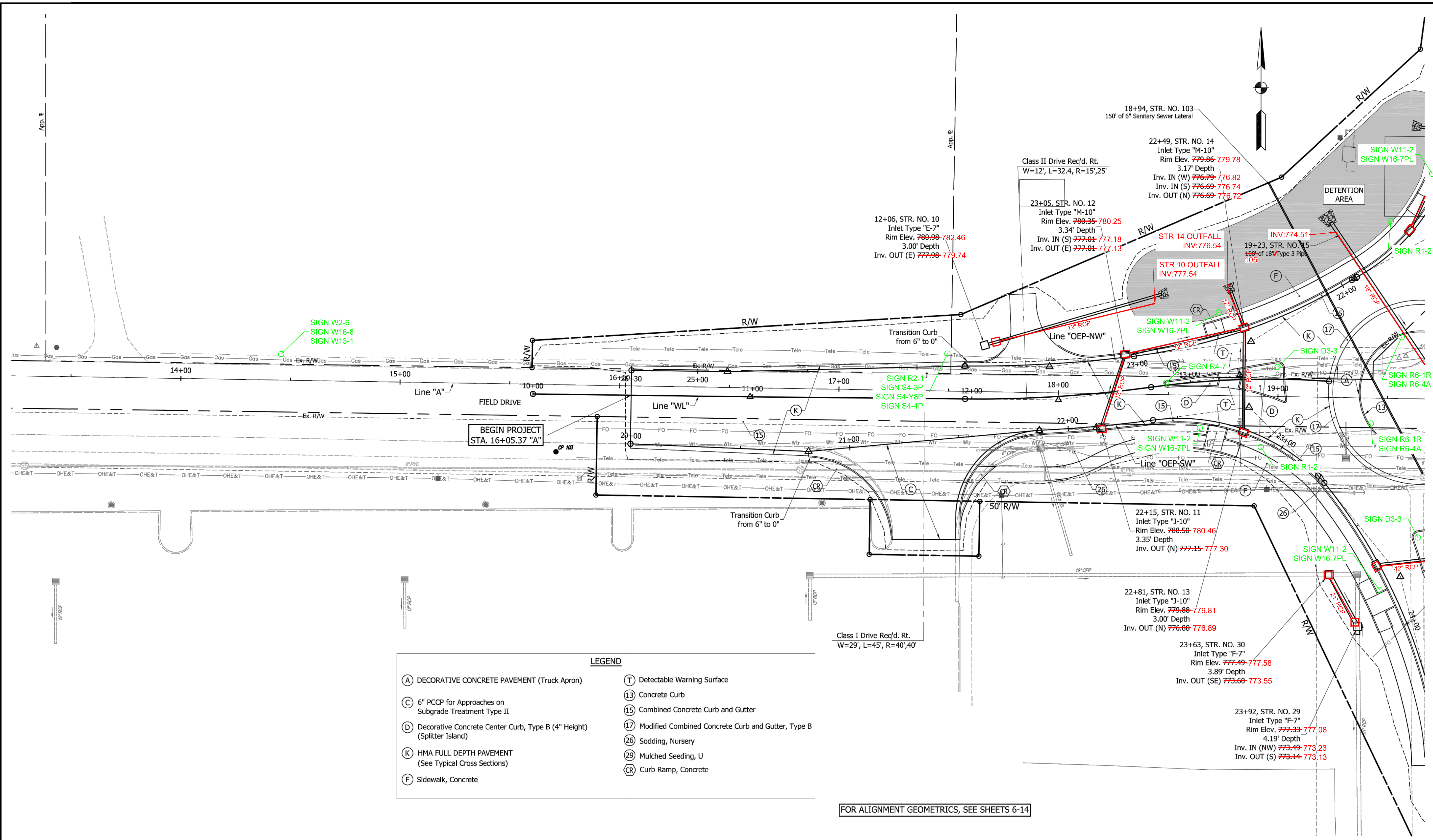

LEGEND

(A) DECORATIVE CONCRETE PAVEMENT (Truck Apron)	(T) Detectable Warning Surface
(C) 6" PCCP for Approaches on Subgrade Treatment Type II	(13) Concrete Curb
(D) Decorative Concrete Center Curb, Type B (4" Height) (Splitter Island)	(15) Combined Concrete Curb and Gutter
(K) HMA FULL DEPTH PAVEMENT (See Typical Cross Sections)	(17) Modified Combined Concrete Curb and Gutter, Type B
(F) Sidewalk, Concrete	(26) Sodding, Nursery
	(29) Mulched Seeding, U
	(CR) Curb Ramp, Concrete

FOR ALIGNMENT GEOMETRICS, SEE SHEETS 6-14

	RECOMMENDED FOR APPROVAL: <i>Mitchell P. Breich</i> 7-27-2018 DESIGN ENGINEER	INDIANA DEPARTMENT OF TRANSPORTATION CONSTRUCTION DETAILS FIELD & CUMBERLAND ROUNDABOUT	HORIZONTAL SCALE 1" = 20'	BRIDGE FILE DESIGNATION 1401714
	DESIGNED: CNC DRAWN: CNC CHECKED: GRW CHECKED: GRW		VERTICAL SCALE N/A	SURVEY BOOK CONTRACT R-38245

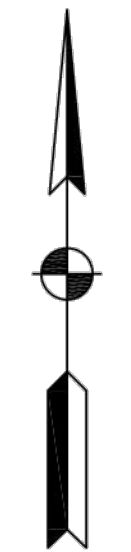
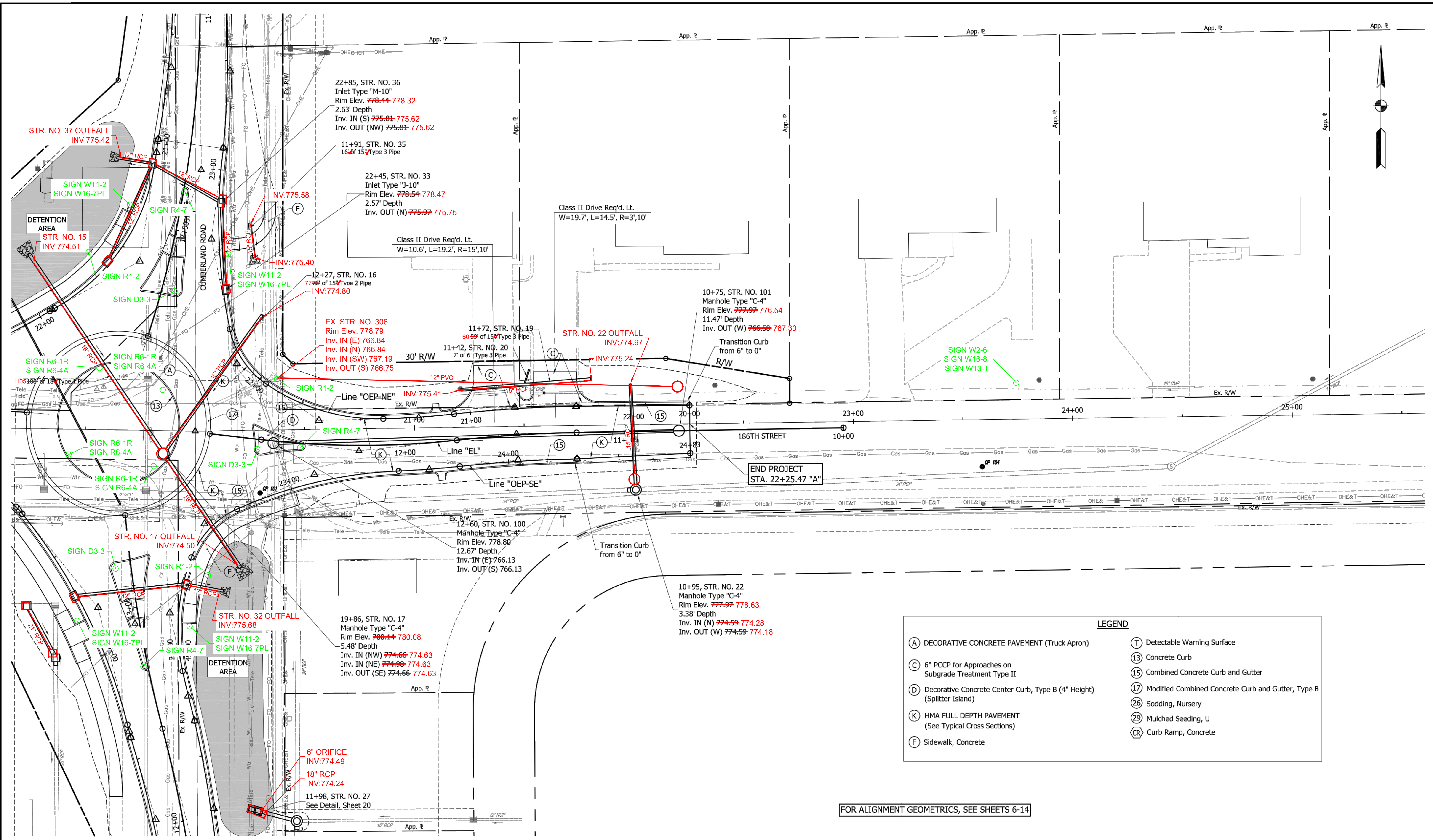

LEGEND

(A) DECORATIVE CONCRETE PAVEMENT (Truck Apron)	(T) Detectable Warning Surface
(C) 6" PCCP for Approaches on Subgrade Treatment Type II	(13) Concrete Curb
(D) Decorative Concrete Center Curb, Type B (4" Height) (Splitter Island)	(15) Combined Concrete Curb and Gutter
(K) HMA FULL DEPTH PAVEMENT (See Typical Cross Sections)	(17) Modified Combined Concrete Curb and Gutter, Type B
(F) Sidewalk, Concrete	(26) Sodding, Nursery
	(29) Mulched Seeding, U
	(CR) Curb Ramp, Concrete

FOR ALIGNMENT GEOMETRICS, SEE SHEETS 6-14

22+85, STR. NO. 36
Inlet Type "M-10"
Rim Elev. ~~778.44~~ 778.32
2.63' Depth
Inv. IN (S) ~~775.81~~ 775.62
Inv. OUT (NW) ~~775.81~~ 775.62

11+91, STR. NO. 35
16" of 15" Type 3 Pipe

22+45, STR. NO. 33
Inlet Type "J-10"
Rim Elev. ~~778.54~~ 778.47
2.57' Depth
Inv. OUT (N) ~~775.97~~ 775.75

Class II Drive Req'd. Lt.
W=19.7', L=14.5', R=3', 10'

Class II Drive Req'd. Lt.
W=10.6', L=19.2', R=15', 10'

12+27, STR. NO. 16
77" of 15" Type 2 Pipe
INV: 774.80

EX. STR. NO. 306
Rim Elev. 778.79
Inv. IN (E) 766.84
Inv. IN (N) 766.84
Inv. IN (SW) 767.19
Inv. OUT (S) 766.75

11+72, STR. NO. 19
60" of 15" Type 3 Pipe

11+42, STR. NO. 20
7" of 6" Type 3 Pipe

10+75, STR. NO. 101
Manhole Type "C-4"
Rim Elev. ~~777.97~~ 776.54
11.47' Depth
Inv. OUT (W) ~~766.59~~ 767.30

Transition Curb from 6" to 0"

12+27, STR. NO. 16
77" of 15" Type 2 Pipe
INV: 774.80

EX. STR. NO. 306
Rim Elev. 778.79
Inv. IN (E) 766.84
Inv. IN (N) 766.84
Inv. IN (SW) 767.19
Inv. OUT (S) 766.75

11+72, STR. NO. 19
60" of 15" Type 3 Pipe

11+42, STR. NO. 20
7" of 6" Type 3 Pipe

10+75, STR. NO. 101
Manhole Type "C-4"
Rim Elev. ~~777.97~~ 776.54
11.47' Depth
Inv. OUT (W) ~~766.59~~ 767.30

Transition Curb from 6" to 0"

12+60, STR. NO. 100
Manhole Type "C-4"
Rim Elev. 778.80
12.67' Depth
Inv. IN (E) 766.13
Inv. OUT (S) 766.13

10+95, STR. NO. 22
Manhole Type "C-4"
Rim Elev. ~~777.97~~ 778.63
3.38' Depth
Inv. IN (N) ~~774.59~~ 774.28
Inv. OUT (W) ~~774.59~~ 774.18

19+86, STR. NO. 17
Manhole Type "C-4"
Rim Elev. ~~780.14~~ 780.08
5.48' Depth
Inv. IN (NW) ~~774.66~~ 774.63
Inv. IN (NE) ~~774.90~~ 774.63
Inv. OUT (SE) ~~774.66~~ 774.63

6" ORIFICE
INV: 774.49

18" RCP
INV: 774.24

11+98, STR. NO. 27
See Detail, Sheet 20

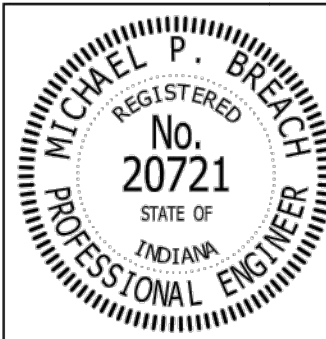

RECOMMENDED FOR APPROVAL: *Mitchell P. Breich* 7-27-2018
DESIGN ENGINEER

DESIGNED: CNC DRAWN: CNC
CHECKED: GRW CHECKED: GRW

INDIANA
DEPARTMENT OF TRANSPORTATION

CONSTRUCTION DETAILS
FIELD & CUMBERLAND ROUNDABOUT

HORIZONTAL SCALE	BRIDGE FILE
1" = 20'	
VERTICAL SCALE	DESIGNATION
N/A	1401714
SURVEY BOOK	SHEETS
	21 of 66
CONTRACT	PROJECT
R-38245	1401714

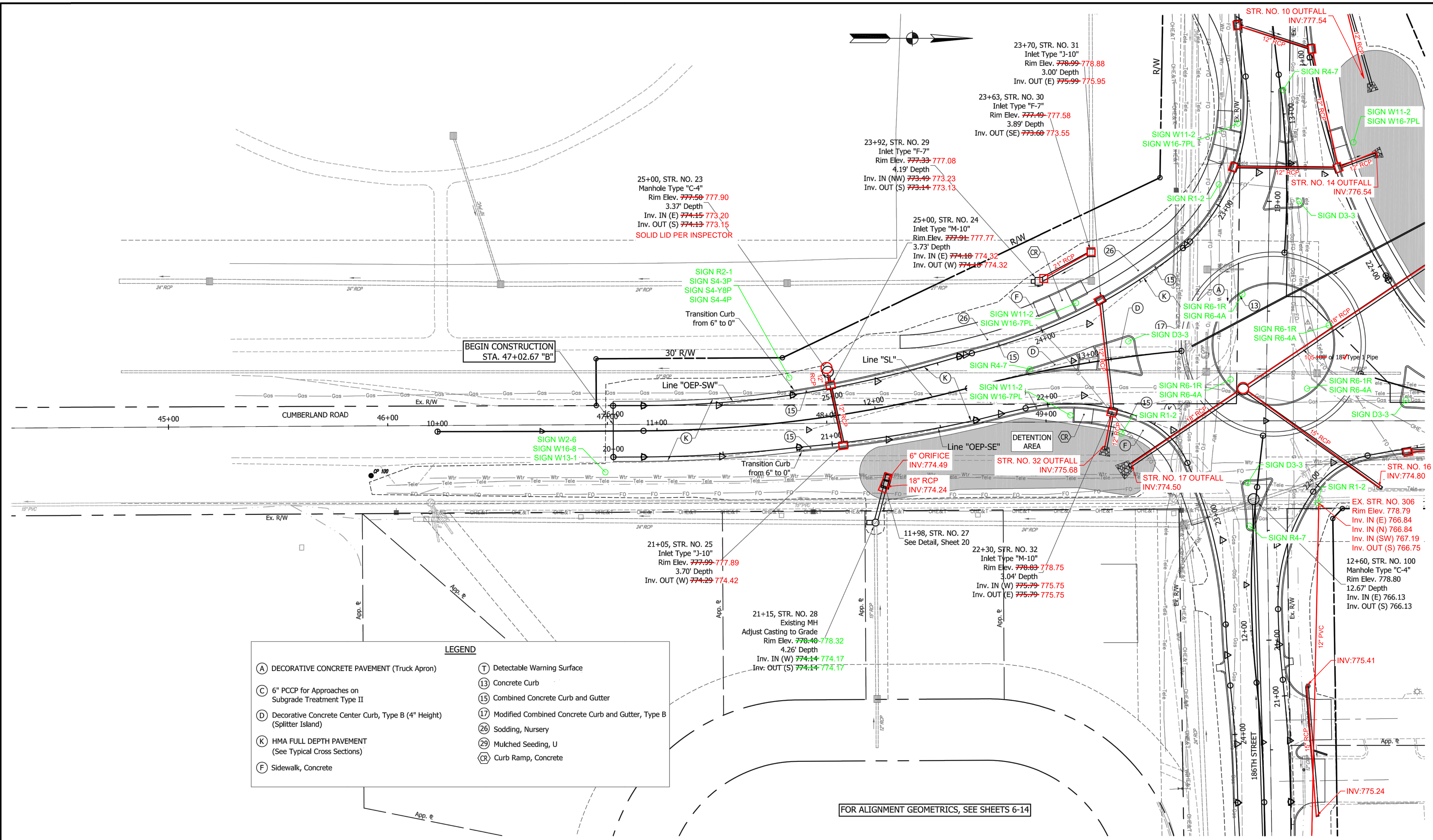

BEGIN CONSTRUCTION
STA. 47+02.67 "B"

LEGEND

(A) DECORATIVE CONCRETE PAVEMENT (Truck Apron)	(T) Detectable Warning Surface
(C) 6" PCCP for Approaches on Subgrade Treatment Type II	(13) Concrete Curb
(D) Decorative Concrete Center Curb, Type B (4" Height) (Splitter Island)	(15) Combined Concrete Curb and Gutter
(K) HMA FULL DEPTH PAVEMENT (See Typical Cross Sections)	(17) Modified Combined Concrete Curb and Gutter, Type B
(F) Sidewalk, Concrete	(26) Sodding, Nursery
	(29) Mulched Seeding, U
	(CR) Curb Ramp, Concrete

FOR ALIGNMENT GEOMETRICS, SEE SHEETS 6-14

	RECOMMENDED FOR APPROVAL <i>Michael P. Breich</i> 7-27-2018 DESIGN ENGINEER	INDIANA DEPARTMENT OF TRANSPORTATION CONSTRUCTION DETAILS FIELD & CUMBERLAND ROUNDABOUT	HORIZONTAL SCALE 1" = 20' VERTICAL SCALE N/A	BRIDGE FILE DESIGNATION 1401714
	DESIGNED: CNC DRAWN: CNC CHECKED: GRW CHECKED: GRW		SURVEY BOOK CONTRACT R-38245	SHEETS 22 of 66 PROJECT 1401714

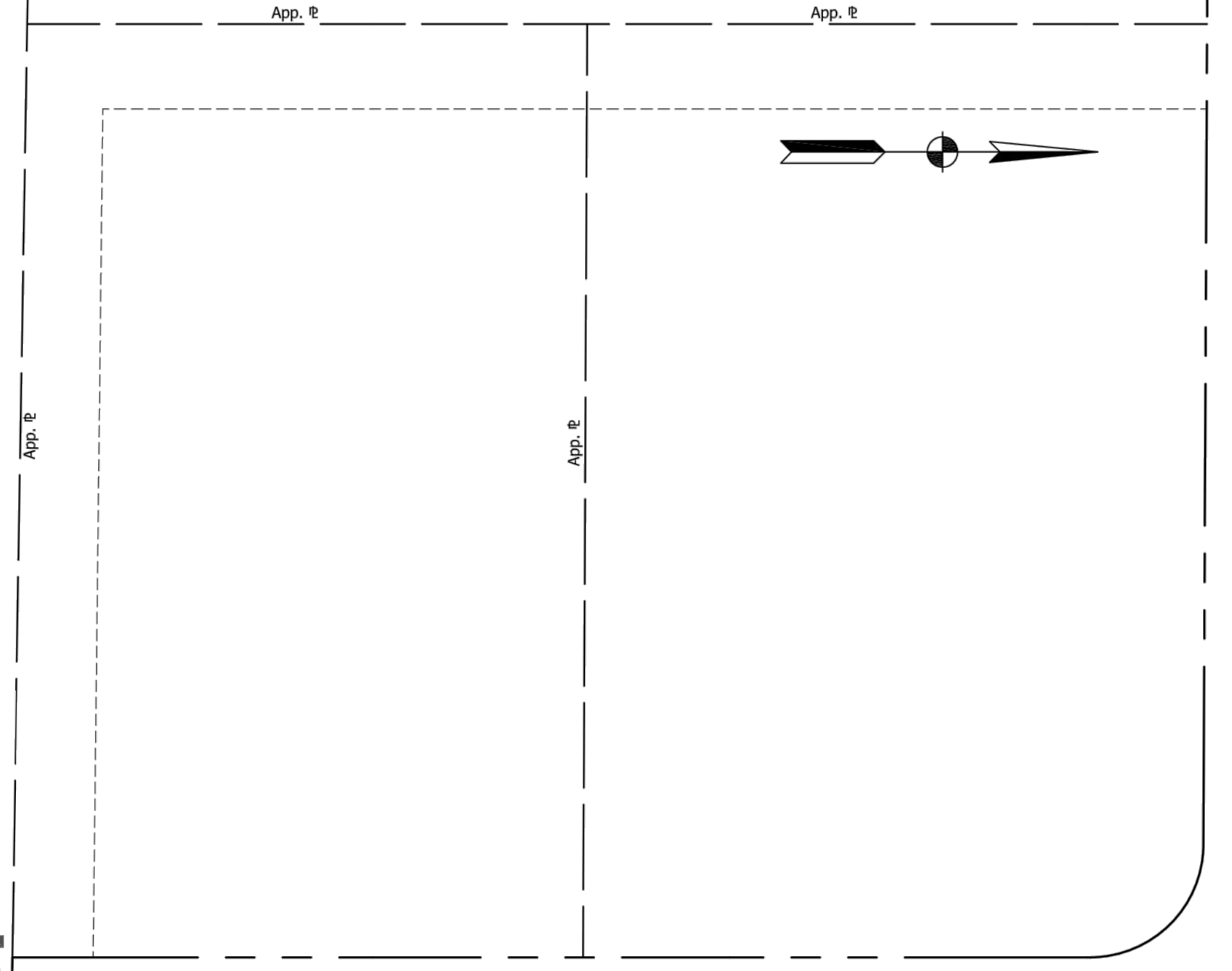
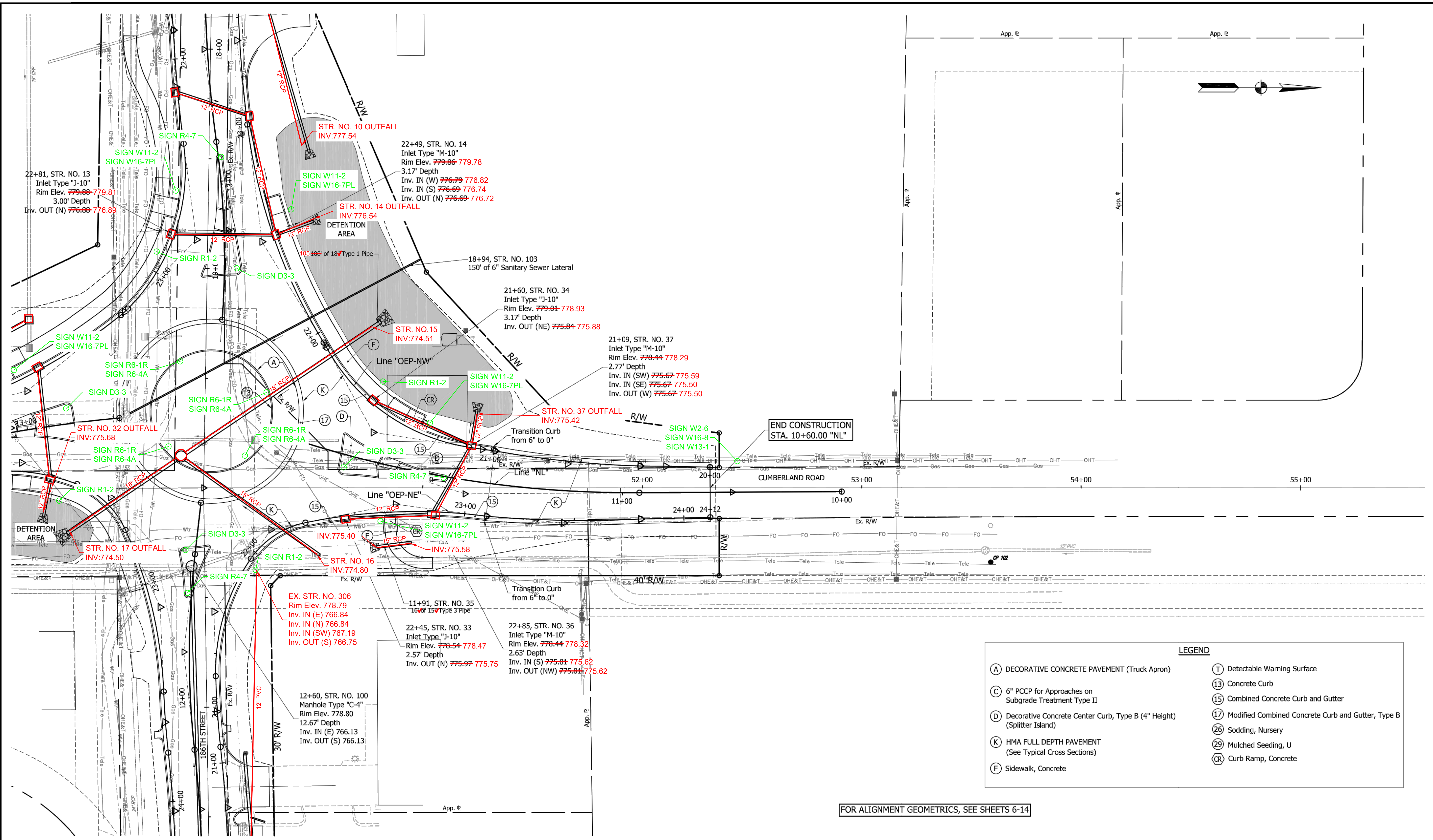

END CONSTRUCTION
STA. 10+60.00 "NL"

FOR ALIGNMENT GEOMETRICS, SEE SHEETS 6-14

LEGEND	
(A) DECORATIVE CONCRETE PAVEMENT (Truck Apron)	(T) Detectable Warning Surface
(C) 6" PCCP for Approaches on Subgrade Treatment Type II	(13) Concrete Curb
(D) Decorative Concrete Center Curb, Type B (4" Height) (Splitter Island)	(15) Combined Concrete Curb and Gutter
(K) HMA FULL DEPTH PAVEMENT (See Typical Cross Sections)	(17) Modified Combined Concrete Curb and Gutter, Type B
(F) Sidewalk, Concrete	(26) Sodding, Nursery
	(29) Mulched Seeding, U
	(CR) Curb Ramp, Concrete

22+81, STR. NO. 13
Inlet Type "J-10"
Rim Elev. 779.88-779.81
3.00' Depth
Inv. OUT (N) 776.88-776.89

22+49, STR. NO. 14
Inlet Type "M-10"
Rim Elev. 779.86-779.78
3.17' Depth
Inv. IN (W) 776.79-776.82
Inv. IN (S) 776.69-776.74
Inv. OUT (N) 776.69-776.72

18+94, STR. NO. 103
150' of 6" Sanitary Sewer Lateral

21+60, STR. NO. 34
Inlet Type "J-10"
Rim Elev. 779.84-778.93
3.17' Depth
Inv. OUT (NE) 775.84-775.88

21+09, STR. NO. 37
Inlet Type "M-10"
Rim Elev. 778.44-778.29
2.77' Depth
Inv. IN (SW) 775.67-775.59
Inv. IN (SE) 775.67-775.50
Inv. OUT (W) 775.67-775.50

STR. NO. 10 OUTFALL
INV:777.54

STR. NO. 14 OUTFALL
INV:776.54

STR. NO. 15
INV:774.51

STR. NO. 32 OUTFALL
INV:775.68

STR. NO. 37 OUTFALL
INV:775.42

STR. NO. 17 OUTFALL
INV:774.50

STR. NO. 16
INV:774.80

STR. NO. 16
INV:775.40

STR. NO. 16
INV:775.58

EX. STR. NO. 306
Rim Elev. 778.79
Inv. IN (E) 766.84
Inv. IN (N) 766.84
Inv. IN (SW) 767.19
Inv. OUT (S) 766.75

11+91, STR. NO. 35
16' of 15" Type 3 Pipe

22+45, STR. NO. 33
Inlet Type "J-10"
Rim Elev. 778.54-778.47
2.57' Depth
Inv. OUT (N) 775.97-775.75

22+85, STR. NO. 36
Inlet Type "M-10"
Rim Elev. 778.44-778.32
2.63' Depth
Inv. IN (S) 775.81-775.62
Inv. OUT (NW) 775.81-775.62

12+60, STR. NO. 100
Manhole Type "C-4"
Rim Elev. 778.80
12.67' Depth
Inv. IN (E) 766.13
Inv. OUT (S) 766.13

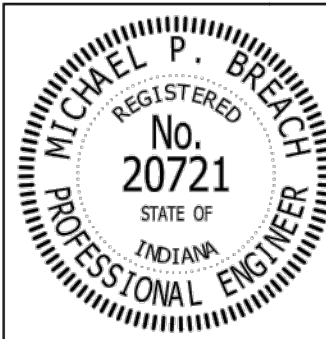

RECOMMENDED FOR APPROVAL: *Mitchell P. Breich* 7-27-2018
DESIGN ENGINEER

DESIGNED: CNC DRAWN: CNC
CHECKED: GRW CHECKED: GRW

INDIANA
DEPARTMENT OF TRANSPORTATION

CONSTRUCTION DETAILS
FIELD & CUMBERLAND ROUNDABOUT

HORIZONTAL SCALE 1" = 20'	BRIDGE FILE
VERTICAL SCALE N/A	DESIGNATION 1401714
SURVEY BOOK	SHEETS
CONTRACT R-38245	23 of 66
	PROJECT 1401714